

AMG350-4G-1C-1S SERIES INDUSTRIAL UNMANAGED SWITCHES WITH OPTIONAL 30/60/90W POE

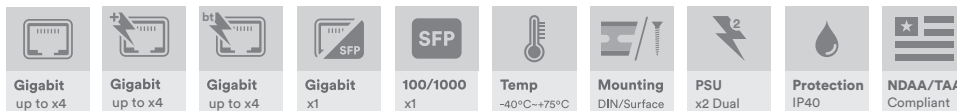

Industrial Ethernet Solutions

AMG's unmanaged Ethernet switches provide 100Mbps or Gigabit Ethernet switching for simple edge network applications with optional 30W or 60/90W PoE. Available with a combination of 4x RJ45, 1x RJ45/SFP combo and 1x SFP port for maximum system flexibility.



[AMG350-4G-1C-1S Series]

/ OVERVIEW

Designed in a compact DIN rail or wall mount housing, the AMG350 series unmanaged Ethernet switches are ideally suited for connecting edge devices to Ethernet networks where more complex management functions are not required. Long distance connections are supported using all types of fiber through the integrated SFP port(s). Fiber connectivity is determined by separate SFP device selection, providing application and site flexibility.

Available in both non-PoE models as well as PoE models for IEEE802.3at 30W or IEEE802.3bt 60/90W they are suitable for powering the latest high powered PoE devices over a wide industrial operating temperature range.

Fitted with dual redundant power inputs and power failure alarm relay ensures maximum operating reliability and the highest levels of performance.

A wide range of models are available to suit all design requirements.

SFPs and PSUs need to be ordered separately.

/ FEATURES

- Compact size – ideal for confined spaces, including camera poles and roadside cabinets
- -40°C to +75°C temperature maintains performance in extreme conditions
- Plug & Play – no need for any user configuration
- DIN rail mountable – quick to install and remove for maintenance
- All SFP ports are multirate 100Mb/Gigabit – support single and multimode, single or dual fiber options up to 120Km
- Dual redundant power inputs with fault relay
- Supports optional 15W, 30W, 60W and 90W PoE
- Auto-Negotiation (802.3u) – automatically determines the best connection speed
- Designed in the USA & UK. Manufactured in the United Kingdom
- AMG Lifetime Support Warranty

Specifications.

Standards.

IEEE802.3i	10Base-T
IEEE802.3u	100Base-TX & 100Base-FX
IEEE802.3ab	1000Base-T
IEEE802.3z	1000Base-X
IEEE802.3af	15W PoE
IEEE802.3at	30W PoE+
IEEE802.3bt	60 & 90W PoE
IEEE802.3x	Flow Control

Jumbo Frames	9.6Kbytes
Address Table	1K MAC Entries
Switch Fabric	12 Gbps
Buffer Memory	1M bits

Interface.

LED Indicators	2x Power SFP Link/Activity RJ45 Link/Activity PoE (PoE Models Only) Alarm (Non-PoE & 30W PoE Models Only) Speed (90W PoE Models Only)
RJ45 Ports	5x 10/100/1000T(X) RJ45 with Auto MDI/MDI-X with 2 kV Isolation Protection
SFP Slots	2x 100/1000FX SFP
Power/Relay	1x 6-way Screw Terminal
DIP Switch	1x 2-way DIP Switch (For SFP Speed & Port 5 Tx/SFP Combo Selection)

Power.

Power Inputs	2
Operating Voltage:	
Non-PoE Models	12-56V _{DC}
30W PoE Models	48-56V _{DC}
90W PoE Models	52-56V _{DC}
Power Consumption	6W Max (without PoE Load)
Total PoE Budget	240W Max (model dependent)
PSE Modes	Mode A (30W Ports) Mode A, Mode B (60/90W Ports)
PoE Enabled Ports	Ports 1-4 (model dependent)
Protection	Reverse Polarity Overload Current
Alarm Relay	Form A 24V @ 1A Max

Packaging.

Shipping Weight:	1.01kg / 2.23lb
Non-PoE & 30W PoE Models	1.09kg / 2.40lb
90W PoE Models	(W x D x H)
Dimensions:	260 × 200 × 60 mm
	10.24 × 7.87 × 2.36 in

Mechanical.

Housing	Anodised Aluminium
Dimensions:	(W x D x H) (Excluding DIN & Wall Mounts)
Non-PoE & 30W PoE Models	47 × 106 × 144 mm
	1.85 × 4.17 × 5.67 in
90W PoE Models	50 × 106 × 144 mm
	1.97 × 4.17 × 5.67 in
IP Rating	IP40
Installation	Wall Mount or DIN-Rail
Weight:	
Non-PoE & 30W PoE Models	0.81kg / 1.79lb
90W PoE Models	0.89kg / 1.96lb

Environmental.

Operating Temp.	-40 to +75°C / -40 to +167°F
Storage Temp.	-40 to +85°C / -40 to +185°F
Humidity	5% to 95% (non-condensing)
MTBF	>500,000 hours
MTBF Standard	MIL-HDBK-217F GF 25°C
Heat Dissipation	20 BTU/h (Non-PoE) 430 BTU/h (with 120W PoE load) 839 BTU/h (with 240W PoE load)
Cooling	Passive Cooling
Noise Level	0 dBA

Regulatory.

Safety	IEC/EN 62368-1
EMI	EN 55032 Class A CISPR 32 EN55024 FCC Part 15B Class A
EMS	EN 61000-4-2 (ESD) EN 61000-4-4 (EFT) EN 61000-4-5 (Surge)
Shock	IEC 60068-2-27
Free Fall	IEC 60068-2-32
Vibration	IEC 60068-2-6
Environmental	Reach, RoHS, WEEE
Traffic	NEMA TS2
Supply Chain	NDA & TAA Compliant

Part Numbers.

6 Port Unmanaged 1Gb Ethernet Switches

AMG350-4G-1C-1S	4x 10/100/1000TX, 1x 100M/1G RJ45/SFP Combo, 1x 100M/1G SFP
AMG350-4GAT-1C-1S-P120	4x 10/100/1000TX 30W PoE (120W Max), 1x 100M/1G RJ45/SFP Combo, 1x 100M/1G SFP
AMG350-4GBT-1C-1S-P240	4x 10/100/1000TX 90W PoE (240W Max), 1x 100M/1G RJ45/SFP Combo, 1x 100M/1G SFP

Included Accessories.

DIN Rail Adapter	Rear Mounted Metal DIN Rail Clip & Screws For DIN Rail Mounting AMG350 Series Products
Wall Mounting Brackets	2x Wall Mounting Brackets & Screws For Wall / Surface Mounting AMG350 Series Products

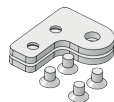
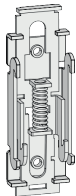

Recommended PSUs.

Non-PoE Models

AMGPSU-W12-P25	Plug Top Mounting Light Industrial Grade PSU, 0 to +70°C, 12VDC, 25W, UK/EU/US Plug Heads Included
AMGPSU-I12-P24	DIN-Rail Mount Industrial Grade PSU, -40 to +70°C, 12VDC, 24W*

PoE Models

AMGPSU-I48-P120	DIN-Rail Mounting Industrial Grade PSU, -40 to +70°C, 47-53VDC, 120W**
AMGPSU-I48-P240	DIN-Rail Mounting Industrial Grade PSU, -40 to +70°C, 48-53VDC, 240W**
AMGPSU-I48-P480	DIN-Rail Mounting Industrial Grade PSU, -40 to +70°C, 48-55VDC, 480W**

* Also available in kit form including mains line cord, DC cable and DIN rail. Order with -K at the end of the part code (e.g. AMGPSU-I48-P120-K).

^ Also available with no exposed mains terminals and direct IEC input kit. Order with -IEC at the end of the part code (e.g. AMGPSU-I48-P120-IEC).

Optional Accessories.

AMG2035	Side Mounted Wall Bracket Adapter Kit For DIN Rail Mounting AMG350 Series Products In Depth Restricted Installations. Adapter Kit Can Be Extended Using The Included Extension Kit To Also Mount A DIN Rail Power Supply Up To 480W
---------	---

In a continuing effort to improve and advance technology, product specifications are subject to change without notice. Please visit www.amgsystems.com for the latest product specifications.